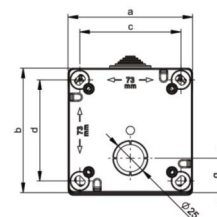
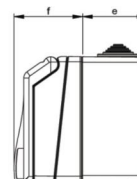
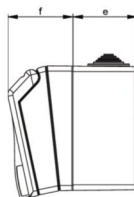

## PCE data sheet

article#	<b>865-4v</b>
article description	<b>CEE-wall socket (surface outlet) Design 16A 5p 4h IP44 (white)</b>
description long	CEE-wall socket (surface outlet) Design 16A 5p 4h IP44 (white) housing material: PC/ABS rated current: 16A number of poles: 5 (3P+N+PE) clock-position: 4h rated voltage/frequency: 57/100V~ - 75/130V~ / 50+60Hz contacts: brass nickel plated connection technology: screw terminals color: white (similar to RAL 9016) wall-/surface-mounting hinged lid with inscription field (optional: key lock) IP protection class: IP44
GTIN (EAN)	9003399932090
country of origin	AT
customs number	85366990
net weight	0.320 kg
packaging quantity	6

ETIM 7.0	EC001318
Current supply	CEE 16 A
Number of poles	5
Voltage acc. EN 60309-2	110 V (50+60 Hz) yellow
Clock hour position	4 h
Identification colour	Yellow
Construction type	Wall mounted socket
Configuration	Cover with text label
Colour	White
RAL-number	9016
Contact material	CuZn
Surface finish contacts	Nickel-plated

wire flexible	1-2,5 mm <sup>2</sup>
wire solid	1-4 mm <sup>2</sup>
contact screws	100 Ncm
dismantling length	50 mm
stripping length	10-12 mm

[www.manufacturer-safety.info](http://www.manufacturer-safety.info)