

PCE data sheet

| | |
|---------------------|--|
| article# | 445-7fe |
| article description | CEE-flanged socket sloping (114x114) 125A 5p 7h IP67 POWER TWIST |
| description long | CEE-flanged socket sloping (114x114) 125A 5p 7h IP67 POWER TWIST housing material: PA6 rated current: 125A number of poles: 5 (3P+N+PE) clock-position: 7h rated voltage/frequency: 277/480V~ - 288/500V~ / 50+60Hz contacts: brass, with lamellar spring (CuBe) connection technology: frame terminals with screws dimensions (flange/fixing center): 114x114 mm / 90x90 mm IP protection class: IP66/IP67 |
| GTIN (EAN) | 9003399767616 |
| country of origin | AT |
| customs number | 85366990 |
| net weight | 0.987 kg |
| packaging quantity | 2 |

| | |
|--------------------------------|------------------------|
| ETIM 7.0 | EC001317 |
| IEC-amperage | 125 A |
| Voltage acc. EN 60309-2 | 500 V (50+60 Hz) black |
| Number of poles | 5 |
| Clock hour position | 7 h |
| Identification colour | Black |
| Degree of protection (IP) | IP67 |
| Connection system | Screwed terminal |
| Angle of plug | Angled |
| Material | Plastic |
| Contact material | CuZn |
| Surface finish contacts | Untreated |
| Flange size vertical | 114 mm |
| Drill hole distance vertical | 90 mm |
| Flange size horizontal | 114 mm |
| Drill hole distance horizontal | 90 mm |

| | |
|--------------------|-----------------------|
| wire flexible | 16-50 mm ² |
| wire solid | 16-70 mm ² |
| contact screws | 450 Ncm |
| dismantling length | 100 mm |
| stripping length | 24-27 mm |

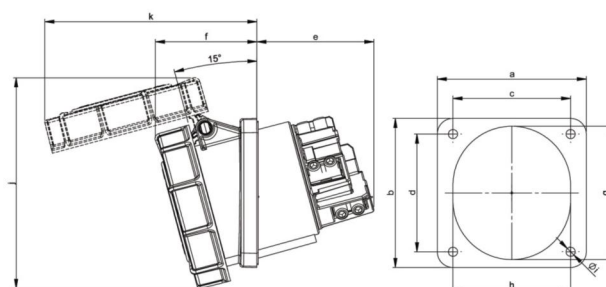

www.manufacturer-safety.info