

## Cable glands Progress® nickel-plated brass with trumpet and clamps

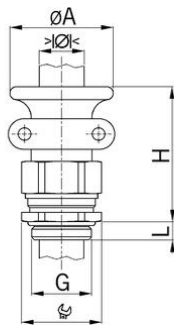

### Short entry thread metric

#### Type approval: Progress MS T+KB

- Two-piece sealing insert
- not overall length insulated

<b>Order number:</b>	<b>1801.10.25</b>
E-No:	121421608
EAN:	7611614127392
Material	Nickel-plated brass
Screws	Stainless steel A2
Seal	TPE
O-ring	NBR
Operation temperature	-40°C / +100°C
Strain relief	Version B acc. to EN 62444
Protection class	IP 68 (up to 10 bar) / IP 69
Entry thread	M25x1.5
Clamping range with insert min.	12.5 mm
Clamping range with insert max.	16.0 mm
Clamping range without insert min.	16.0 mm
Clamping range without insert max.	20.5 mm
Wrench size	30 mm
Diameter A	44
Dimension H	52 mm
Thread length L	7 mm
Dispatch	25

Available with sealing inserts conformity with EN 45545 / NFPA 130. When placing an inquiry, prefix the article number by the capital F.