

# Product End of Life Instructions

**TeSys Deca contactor 3P AC-3 50A 230V Everlink**

**TeSys Deca contactor**

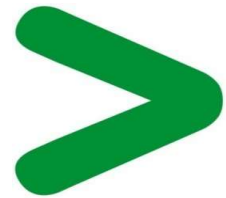



## End of Life Instructions

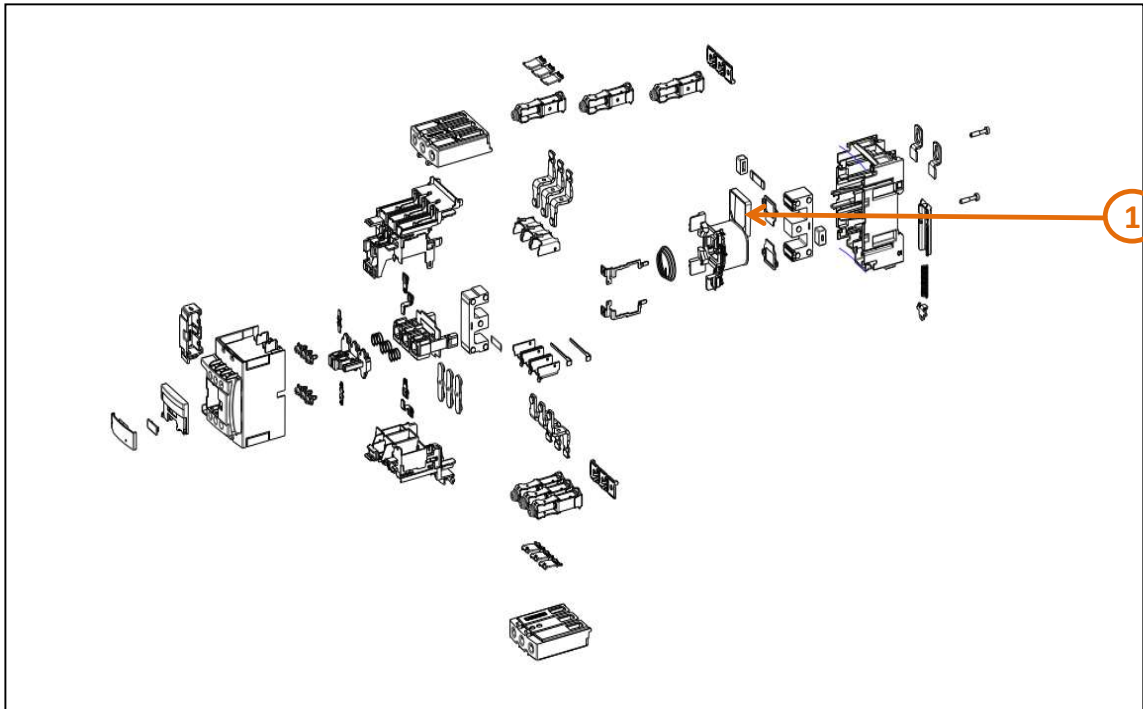

Recommendation	Number on drawing	Component / Material	Weight (in g)	Comment
To be depolluted	1	Other plastic parts with brominated flame retardants	17.8g	



## Product description

Manufacturer identification	Schneider Electric Industries SAS
Brand name	Schneider Electric
Product function	The main purpose of the product is to switch on and off electrical power supply of a downstream installation with an electrical and/or mechanical control.
Product reference	LC1D50AP7
Additional similar product references	LC1D/LC2D 40 or 50 or 65 or 80 followed by Axx or A3xx or A6xx; LC1DT 60 or 80 followed by Axx or A3xx or A6xx LC1D40Axx maybe followed by S003 LC1D65Axx maybe followed by S219 DEP 40 or 50 or 65 Followed by G7/U7/P7/B7
Total representative product mass	848 g
Representative product dimensions	118 x 55 x 117mm
Accessories	No
Date of information release	2023/10/11

## Additional information

Legal information	This product family is in the scope of European Union directive 2012/19/EU on Waste Electrical and Electronic Equipment (WEEE). The product family must be disposed according to the legislation of the country. This document is intended for use by end of life recyclers or treatment facilities. It provides the basic information to assure an appropriate end of life treatment for the components and materials of the product.	
In case of special transportation: transportation method	No	
Recyclability potential	<b>63%</b>	Recyclability rate has been calculated based on REEECY'LAB tool developed by Ecosystem, for components/materials not covered by the tool, data from the "ECO' DEEE recyclability and recoverability calculation method" was taken. If no data was found a conservative assumption was used (0% recyclability).

Schneider Electric Industries SAS  
Country Customer Care Center  
<http://www.schneider-electric.com/contact>

35, rue Joseph Monier  
CS 30323  
F- 92500 Rueil Malmaison Cedex  
RCS Nanterre 954 503 439  
Capital social 896 313 776 €

[www.se.com](http://www.se.com)

ENVEOLI1503009\_V3

Published by Schneider Electric

© 2023 - Schneider Electric – All rights reserved

2023/10/11