

-10°C ... +70°C	-5°C ... +35°C

**A**

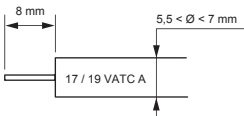

Z			Control	Return Path	Channel 1	Channel FM	Channel VHF	Channel UHF	Channel SAT (IF)
75 $\Omega$	< 1,5 dB	500 mA	22 kHz 0,6 V	4 - 30 MHz	47 - 68 MHz	87,5 - 240 MHz	120 - 470 MHz	470 - 862 MHz	950 - 2400 MHz

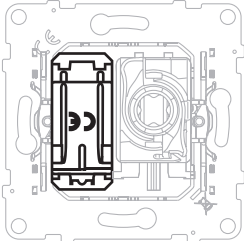

**1**

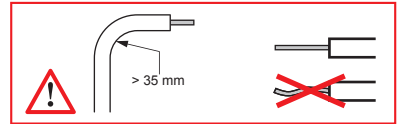
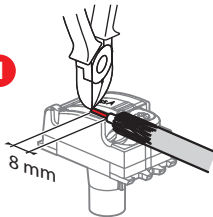

**2**

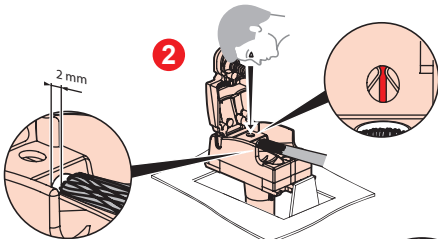

**3**

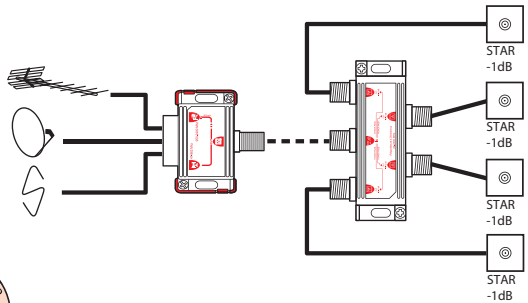
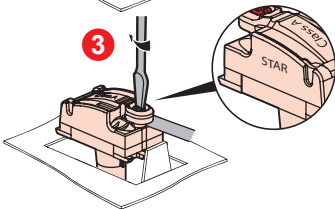

**B**

RJ 45 UTP  
Cat6

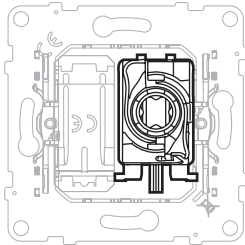
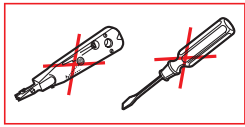

U/UTP

0 332 62

> 50 mm

U/UTP

1 2 3

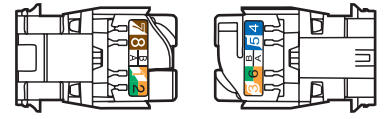
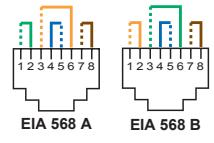

1 2 3 4 5 6 7

CLIC

**C**

1 2