

# Plexo™ Switches and two-ways

Cat. Nos.: 0 695 11/12/13/15/16/19/21/23/24/25/26/27/28/30/31/32/38  
 0 696 11/12/13/15/19/25/26/27/29 - 0 697 10/11/12/13/14/15/16/17/18/51/52/53/54/55/56/58  
 0 698 11/12/17/51/52/55/56 - 0 707 11/26/27

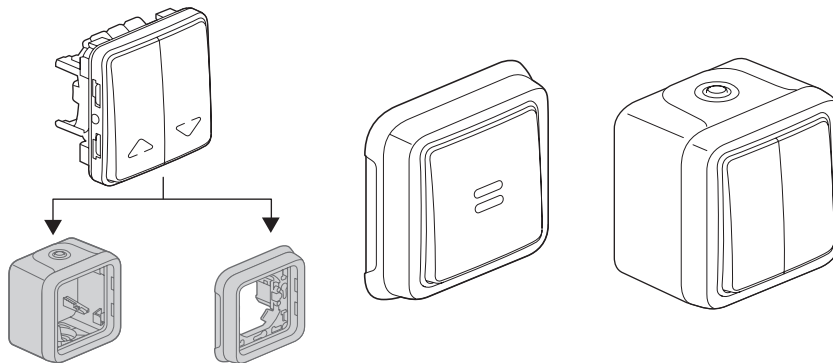

## 1. USE

Weatherproof wiring devices system intended for residential and professional technical premises (garages, cellars, car parks, workshops and industrial kitchens, etc.) as well as outdoor environments (patios, terraces, gardens, camping sites, etc.).  
 Lighting control mechanisms with or without indicating (lights) or signalling (marking) components.

### Antimicrobial\* products:

These products are made of silver-ion based antimicrobial\* material. This technology eliminates bacteria, fungi and viruses without creating any immunisation or resistance effects (physical, rather than chemical, destruction).  
 Particularly suitable for healthcare establishments (hospitals, clinics, nursing homes, laboratories, waiting rooms, etc.) and more generally for areas subject to hygiene restrictions (industrial, shared and restaurant kitchens, waste, etc.).  
 These products offer an additional way of ensuring the non-proliferation of bacteria, fungi and viruses without interfering with cleaning protocols.

## 2. RANGE

2 versions : grey and white		References
<b>Configurable</b>		0 695 11/12/13/15/16/19/21/23/24
		0 695 25/26/27/28/30/31/32/38
		0 696 11/12/13/15/19/25/26/27/29
		0 707 11/26/27 (Antibacterial* Artic White)
<b>Surface-mounting complete</b>		0 697 10/11/12/13/14/15/16/17/18
		0 697 51/52/53/54/55/56/58
<b>Flush-mounting complete</b>		0 698 11/12/17
		0 698 51/52/55/56

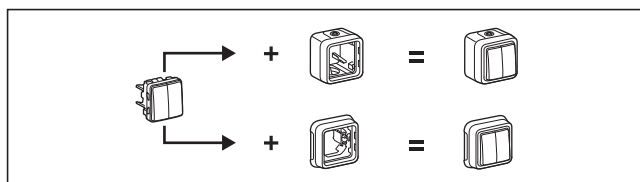

## 3. PREPARATION

### 3.1 Surface-mounting

- By screwing the base box onto the support using 2 screws Ø 3-4 mm max.

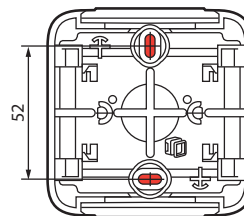

### 3.2 Flush-mounting

- Frame dismantling

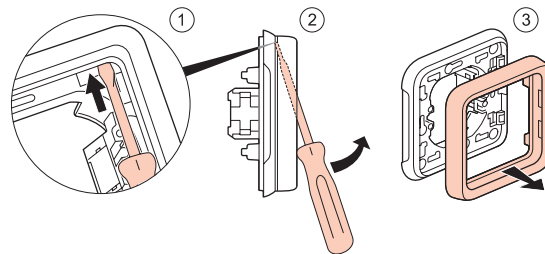

- By screwing onto a flush-mounting box

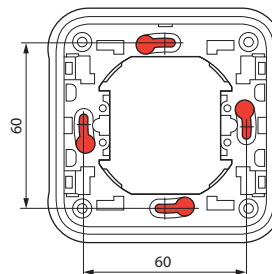

- By claws onto a flush-mounting box

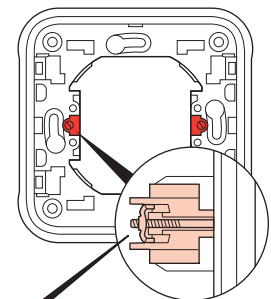

Possibility to place claws:  
 Cat. No. 0 849 00 or Cat. No. 0 849 01 (long claw)

**3. PREPARATION (continued)**

**3.2 Flush-mounting**

- By face plate using 4 screws Ø 4 mm  
Piercing of support material for diameter 60-70 mm using cylinder saw or punch.

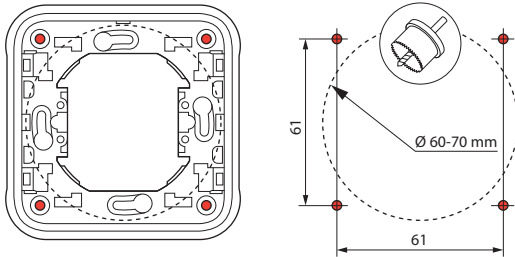

**4. OVERALL DIMENSIONS (mm)**

**Configurable**

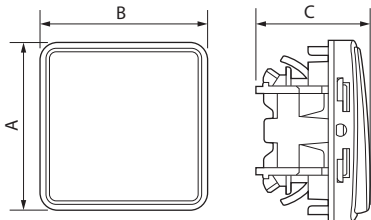

**Surface-mounting**

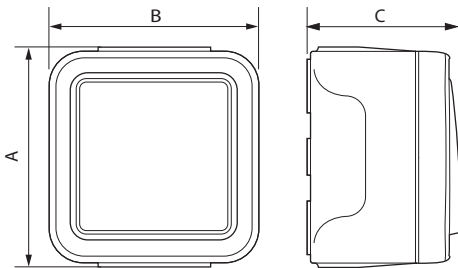

**Flush-mounting**

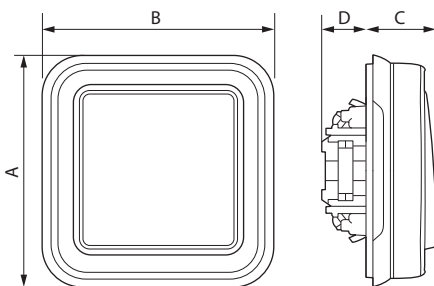

	A	B	C	D
<b>Configurable</b>	64	64	40	-
<b>Surface-mounting</b>	84	80	57	-
<b>Flush-mounting</b>	86	86	23	19

**5. CONNECTION**

**Connection to conductors**

• 1 break

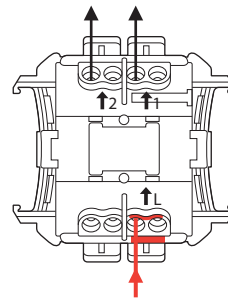

• 2 breaks

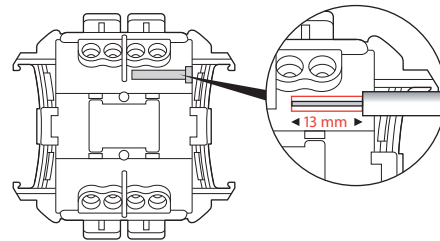
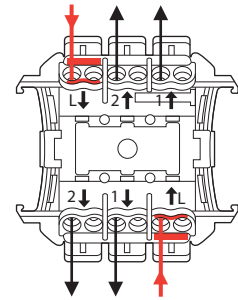

Type of terminals: automatic  
Terminal capacity: 1.5 mm<sup>2</sup> - 2.5 mm<sup>2</sup> (1 or 2 conductors)  
Stripping length: 13 mm

**6. TECHNICAL CHARACTERISTICS**

**6.1 Protection index**

Protection against solid bodies and liquids: IP 55  
Protection against impact: IK 07

**6.2 Material characteristics**

Box, support: PP reinforced  
Front plate, rocker: ABS  
Entry gland, cover plate: PP + SEBS  
Mechanism: PC

UV-resistant  
Halogen-free

Resistance to salt spray: 7 days (168 h)

Self-extinguishing:

850°C/30 s for insulating components holding live parts in place.  
650°C/30 s for other insulating components.

**6.3 Electrical characteristics**

Current: 10 AX  
Current: 6 AX for Cat. Nos. 0 695 15 - 0 696 15  
Max. power for self-ballasted lamps (LED lamps and fluocompact): 100 W

Current: 16 AX for Cat. Nos. 0 695 23/24/27/28  
Max. power for self-ballasted lamps (LED lamps and fluocompact): 200 W

Voltage: 250 V~  
Frequency: 50 Hz

**6.4 Climate characteristics**

Storage temperature: - 25°C to + 70°C  
Usage temperature: - 20°C to + 40°C

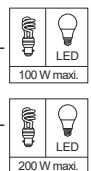

## 7. CLEANING

Surface cleaning with a cloth.  
Do not use: acetone, tar remover, trichloroethylene.

**Antimicrobial\* products:**

Resistance to hospital-type cleaning products: Anios, Surfanios, Bactily sine,  
Hydrogen peroxide (35%).

**Caution:** Always test before using other special cleaning products.

## 8. STANDARDS AND APPROVALS

Compliant with installation and manufacturing standards.  
Refer to e. catalogue.

\*Contains silver ions that limit the development of bacteria on the surface.