

Product End of Life Instructions

RP Series Expansion Remote Control RP-C-RC-BLE

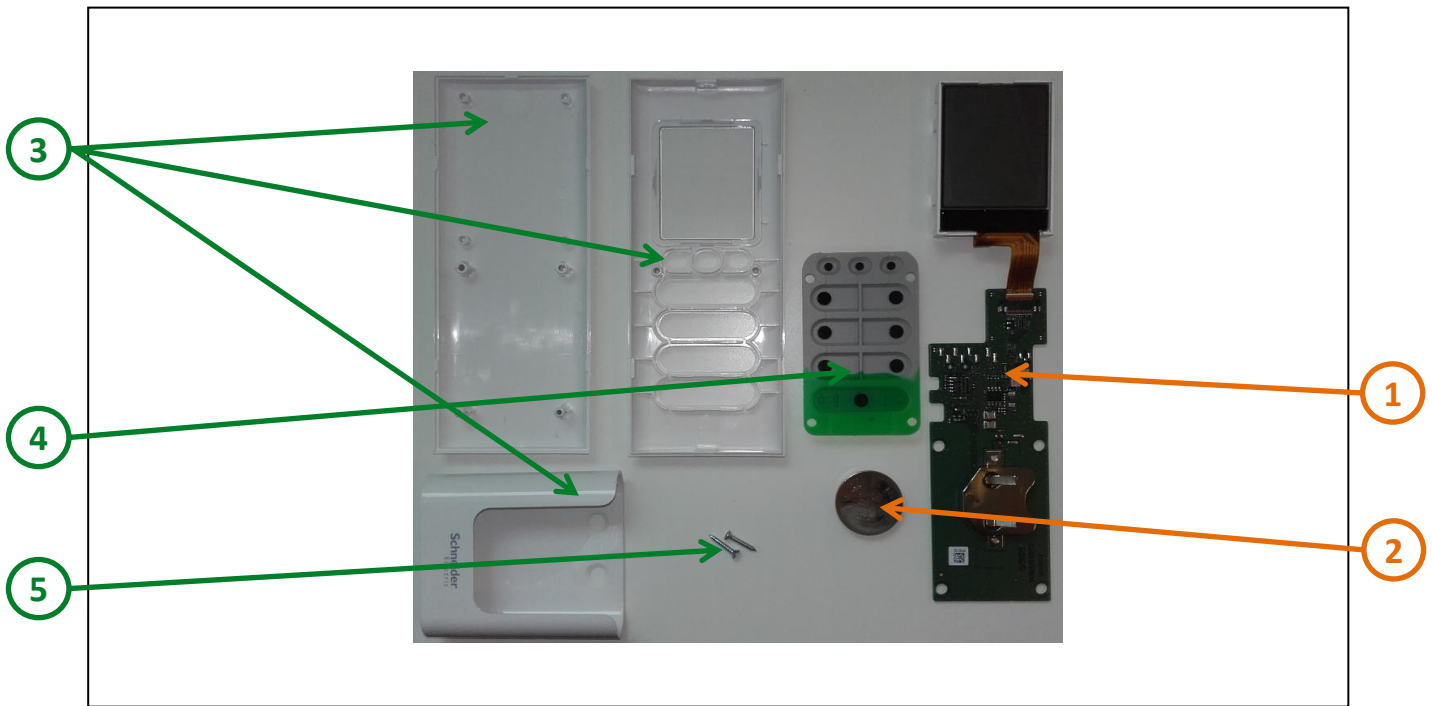

End of Life Instructions



Recommendation	Number on drawing	Component / Material	Weight (in g)	Comment
To be depolluted	1	Electronic Board (Communication) > 10cm ²	33	Including LCD-module
To be depolluted	2	Other battery	6	Li-Mn Button Cell
To be dismantled	3	PC Plastic	54	
Other	4	Silicone Rubber	11	
To be dismantled	5	Steel	1	

Product description

Manufacturer identification	Schneider Electric Industries SAS
Brand name	Schneider Electric
Product function	The RP-C-RC-BLE Remote Control enables the occupants of modern office buildings to control the comfort level of their space.
Product reference	SXWRERCBLE10001
Total representative product mass	105 g
Representative product dimensions	145mm x 62mm x 18mm
Date of information release	09/2020



Additional information

Legal information

This product family is in the scope of European Union directive 2012/19/EU on Waste Electrical and Electronic Equipment (WEEE). The product family must be disposed according to the legislation of the country. This document is intended for use by end of life recyclers or treatment facilities. It provides the basic information to assure an appropriate end of life treatment for the components and materials of the product.

Recyclability potential

56%

Based on "ECO'DEEE recyclability and recoverability calculation method" (version V1, 20 Sep. 2008 presented to the French Agency for Environment and Energy Management: ADEME).

Schneider Electric Industries SAS
 Country Customer Care Center
<http://www.schneider-electric.com/contact>
 35, rue Joseph Monier
 CS 30323
 F- 92506 Rueil Malmaison Cedex
 RCS Nanterre 954 503 439
 Capital social 896 313 776 €

www.schneider-electric.com

ENVEOLI2009016_V1

Published by Schneider Electric

© 2019 - Schneider Electric – All rights reserved

09/2020